

mastix sa

Route Aloys-Fauquez 28
CH 1018 Lausanne

Phone +41216482949
Fax +41216483172
Email mastix@mastix.ch
Internet www.mastix.ch

BFL-Mastix bands

Joints in concrete structures

Work joint
Strinkage joint
Setting joint
Programmed shrinkage joint

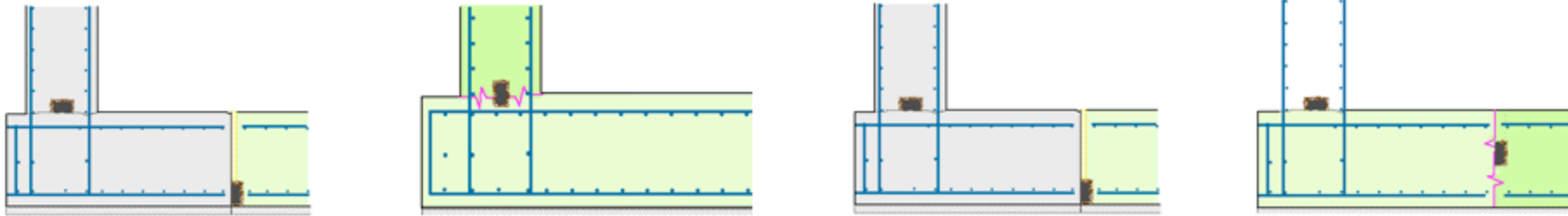

Applications

Raft - raft

Raft - wall

Summary of courant applications of the **BFL-Mastix** bands

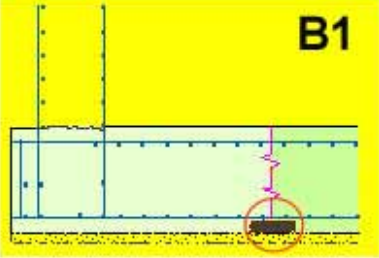
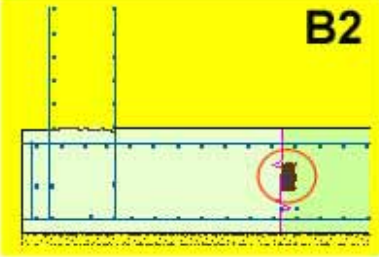
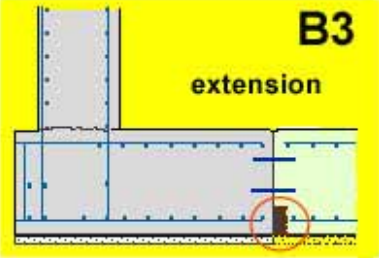
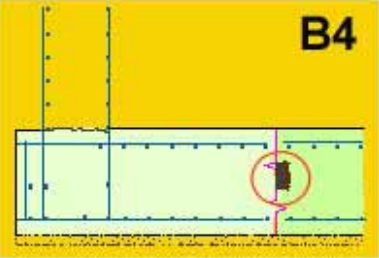
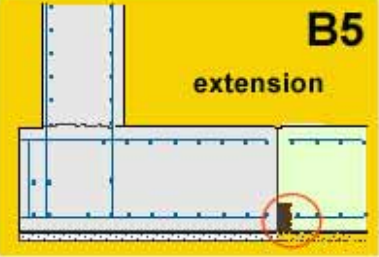
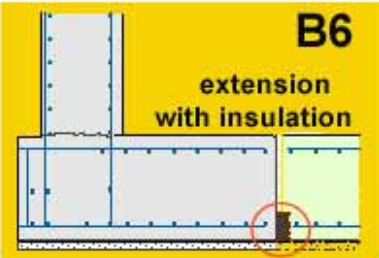
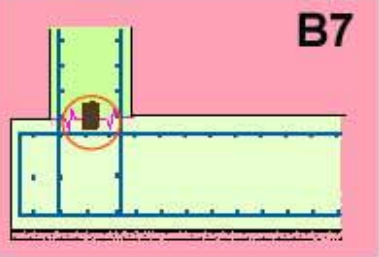
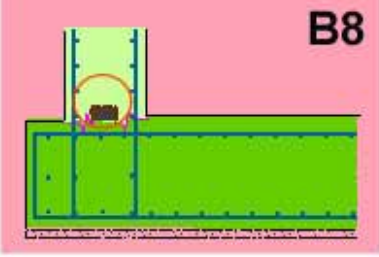
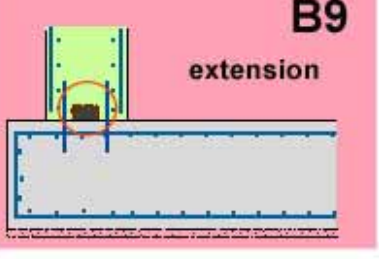
	work joints	shrinkage/settling joints
raft/raft	<p>B1</p>  <p>B2</p>  <p>B3 extension</p> 	<p>B4</p>  <p>B5 extension</p>  <p>B6 extension with insulation</p> 
raft/wall	<p>B7</p>  <p>B8</p>  <p>B9 extension</p> 	

Work joint between concreting stages of a foundation raft

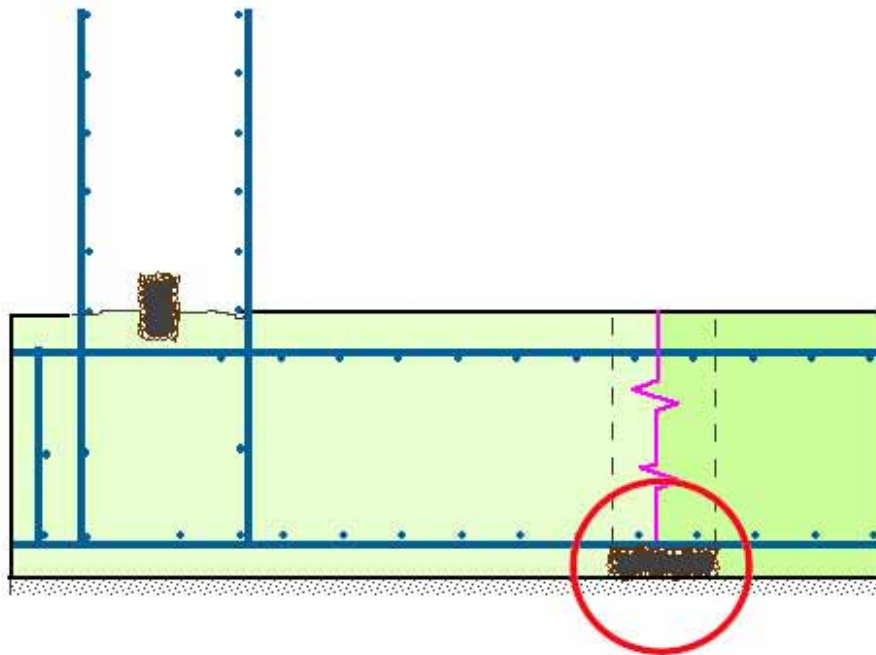

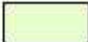
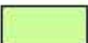
-  lean concrete
-  1st concreting stage
-  2nd concreting stage

Choice of a BFL-Mastix band

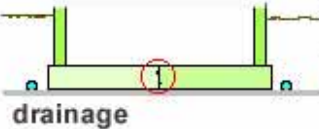
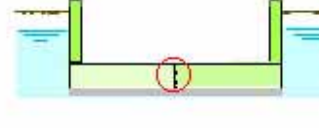
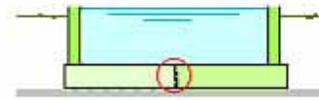
risk of water infiltration	bands
 <p>subsoil water - rain - spring drainage</p>	<p>20/70 R4 20/120 R4</p>
 <p>water level - permanent - intermittent</p>	<p>20/70 R4 20/120 R4</p>
 <p>- swimming pool - basin - reservoir</p>	<p>20/70 R4 20/120 R4</p>

Way of application



The bands are placed on the lean concrete and fixed with nails

[back](#)

B1

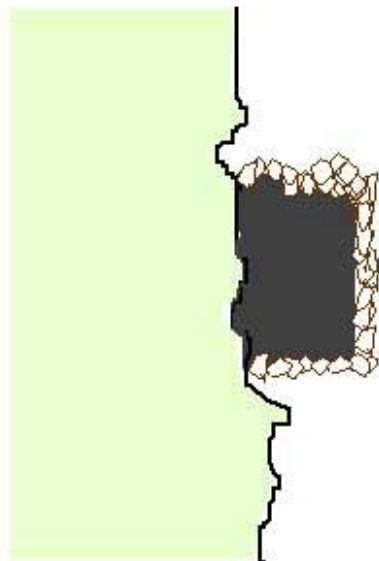
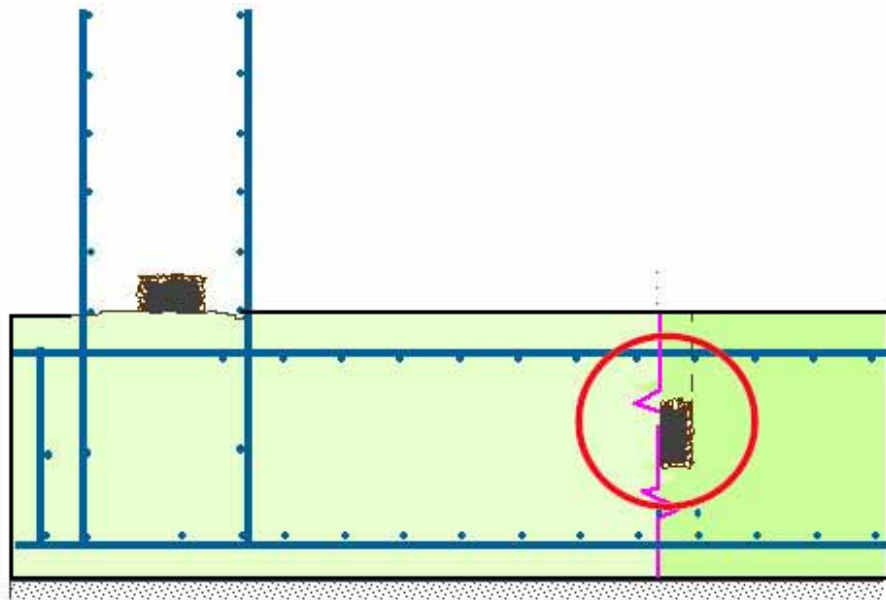
Work joint between concreting stages of a foundation raft

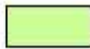

-  lean concrete
-  1st concreting stage
-  2nd concreting stage

Choice of a BFL-Mastix band

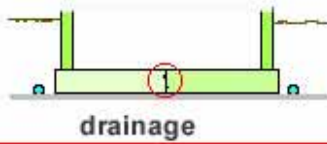
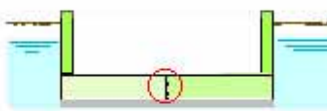
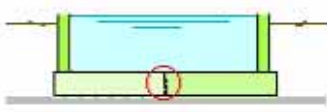
risk of water infiltration		bands
 <p>subsoil water - rain - spring</p> <p>drainage</p>	1	30/40 R
 <p>water level - permanent - intermittent</p>	2	20/70 R
 <p>- swimming pool - basin - reservoir</p>		30/40 R

Way of application

- 1** The bands are hot glued
- 2** The bands are applied with 2-components epoxy glue.

[back](#)

B2

Work joint between an old foundation raft and a new one

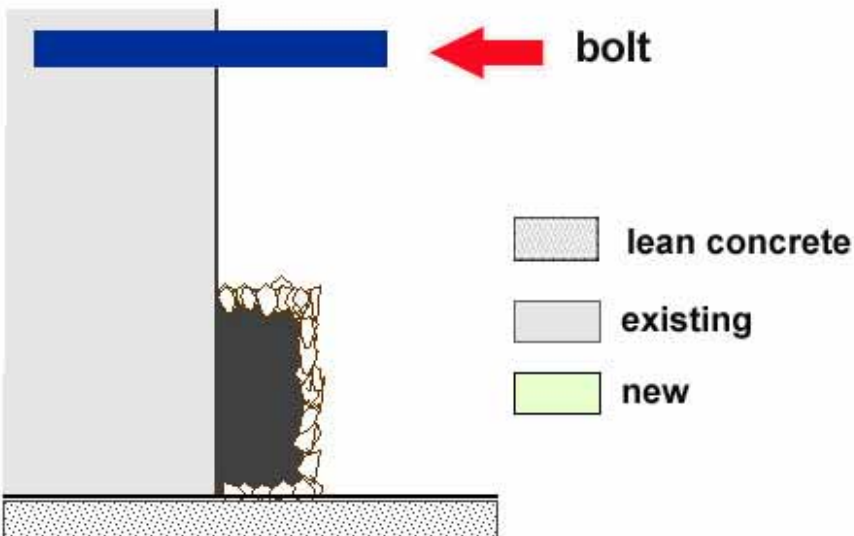
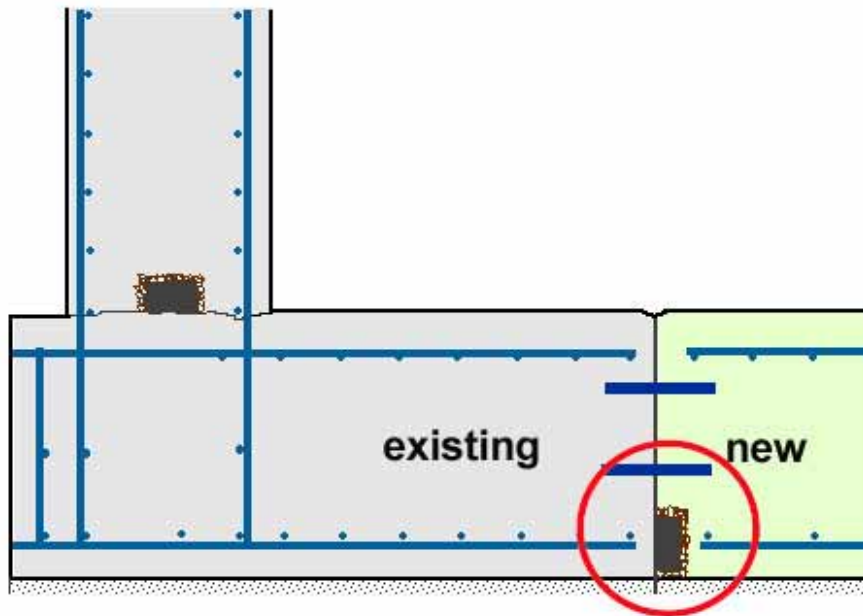

Choice of a BFL-Mastix band

risk of water infiltration		bands
<p>subsoil water - rain - spring drainage</p>	1	30/40 R
<p>water level - permanent - intermittent</p>	2	20/70 R 30/40 R
<p>swimming pool - basin - reservoir</p>		

Way of application

- 1** The bands are hot glued
- 2** The bands are applied with a 2-components epoxy glue.

[back](#)

B3

Shrinkage and settling joint in a foundation raft

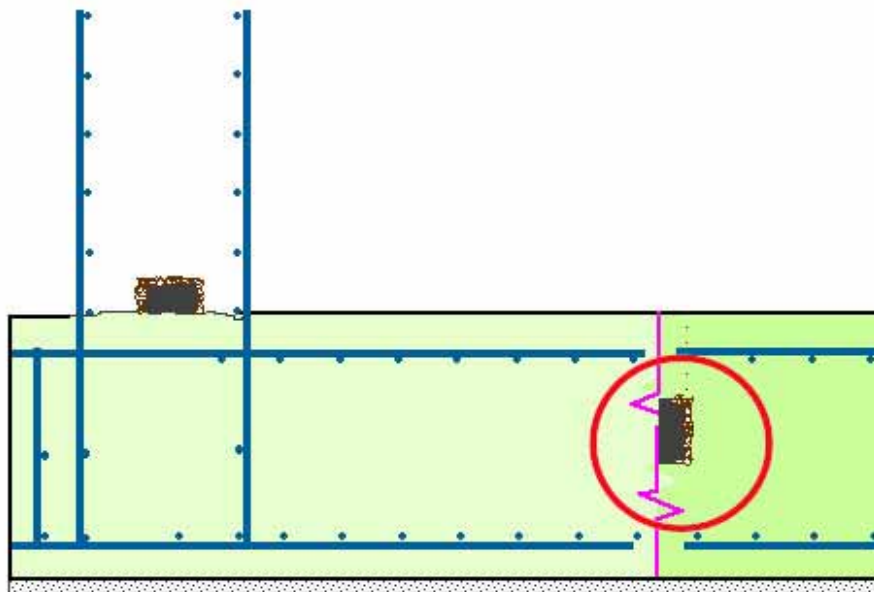

The bands are capable to support traction and shear movements

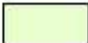
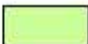

-  lean concrete
-  1st concreting stage
-  2nd concreting stage

Choice of a BFL-Mastix band

risk of water infiltration

bands

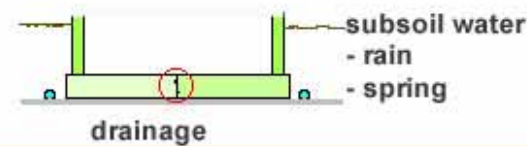

1 40/50 R4 1/2D

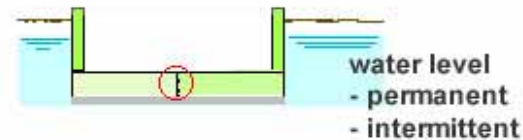

2 40/50 R4 1/2D
40/70 R4 1/2D

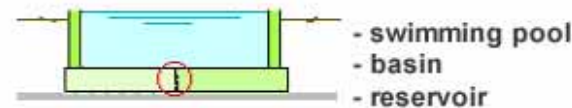

Way of application

- 1** The bands are hot glued
- 2** The bands are applied with a 2-components epoxy glue and confinement string

[back](#)

B4

Shrinkage and settling joint between an old foundation raft and a new one

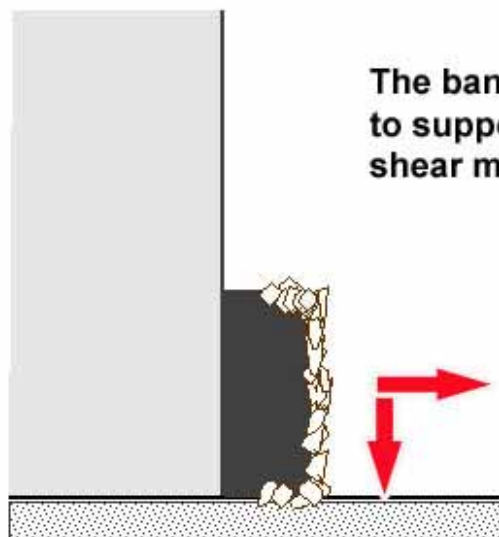
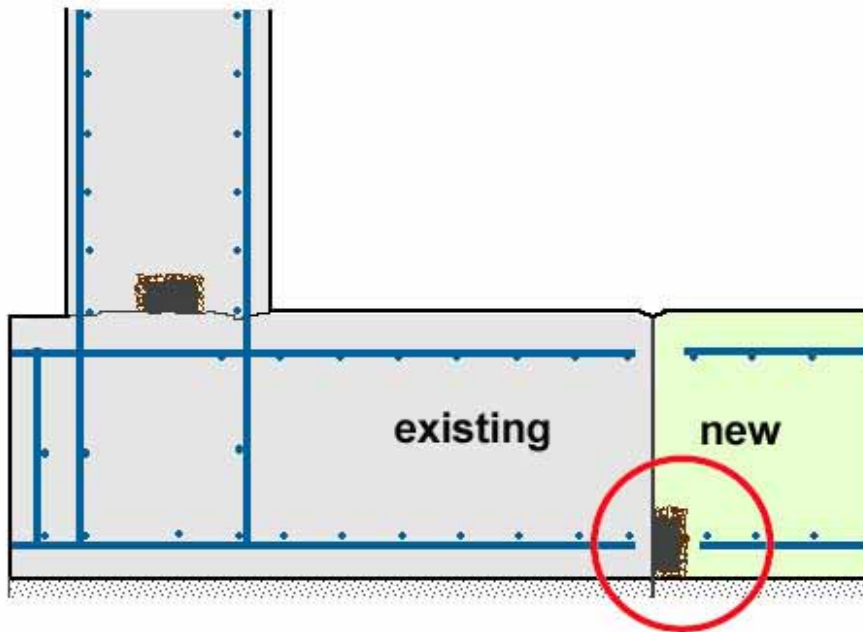

The bands are capable to support traction and shear movements

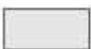
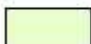
-  lean concrete
-  existing
-  new

Choice of a BFL-Mastix band

risk of water infiltration

bands

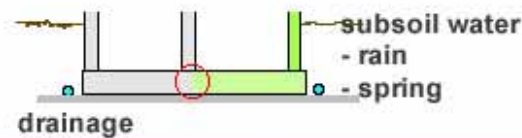

1 40/50 R41/2D



2 40/50 R41/2D
40/70 R41/2D

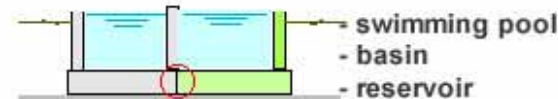

Way of application

- 1** The bands are hot glued
- 2** The bands are applied with a 2-components epoxy glue and confinement string

[back](#)

B5

Shrinkage and settling joint between an old foundation raft and a new one

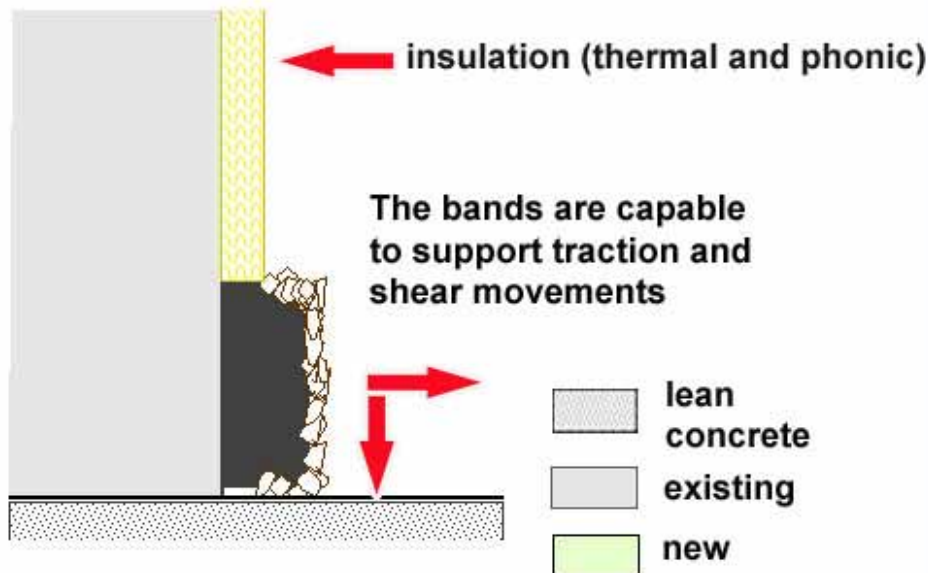
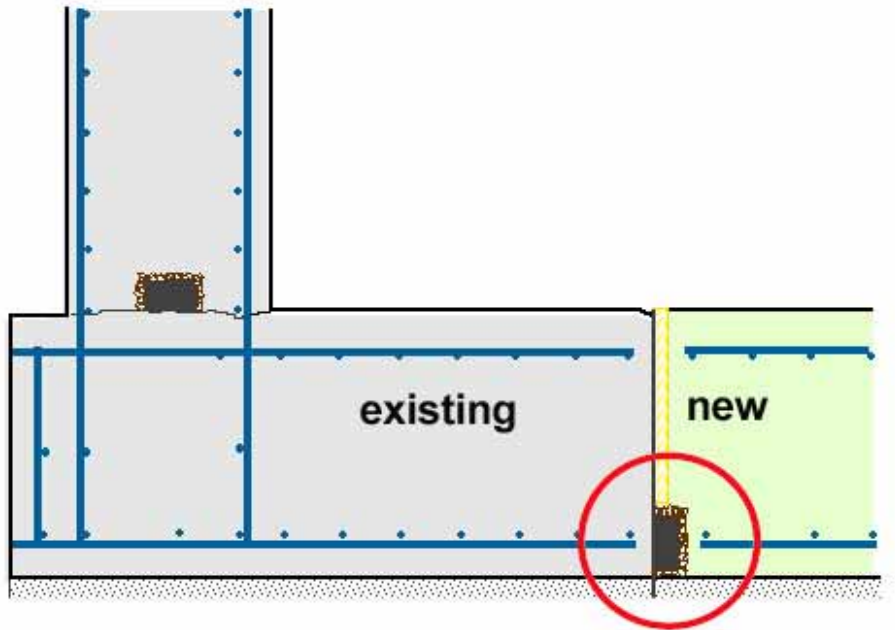

Choice of a BFL-Mastix band

risk of water infiltration

bands

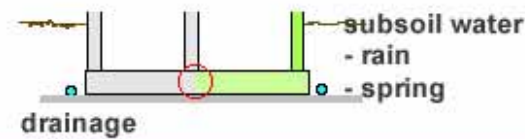

1 40/50 R41/2D

Way of application

- 1** The bands are hot glued or with a 2-components epoxy glue

[back](#)

B6

Work joint between foundation raft and wall

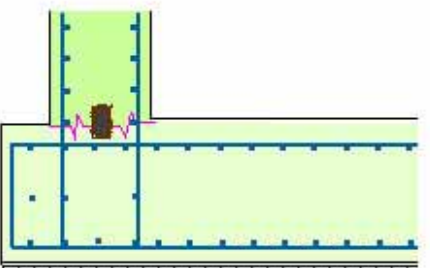
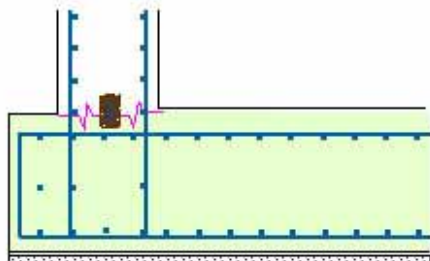
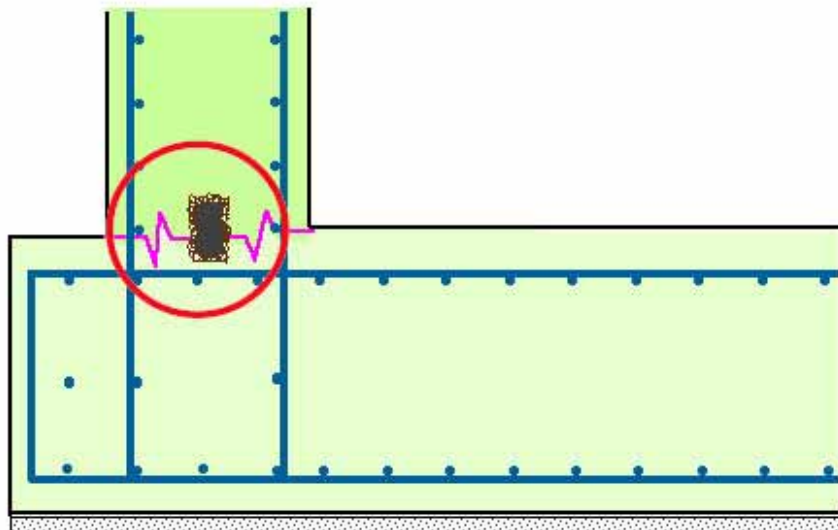

-  lean concrete
-  raft concrete
-  wall concrete

Choice of a BFL-Mastix band

risk of water infiltration

bands

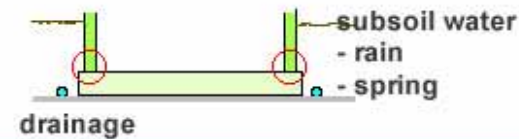

20/70 R4

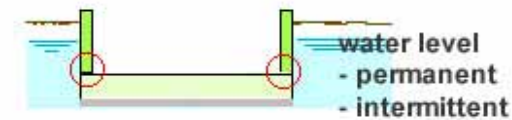

20/70 R4
40/70 R4

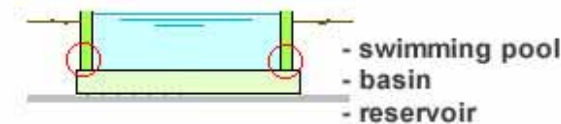

Way of application

The bands are incorporated in the fresh raft concrete.



They can remain there for several weeks, regardless the weather conditions.

[back](#)

B7

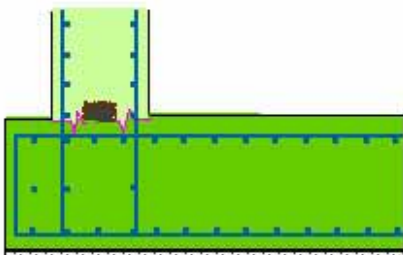
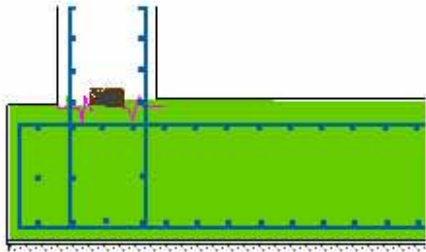
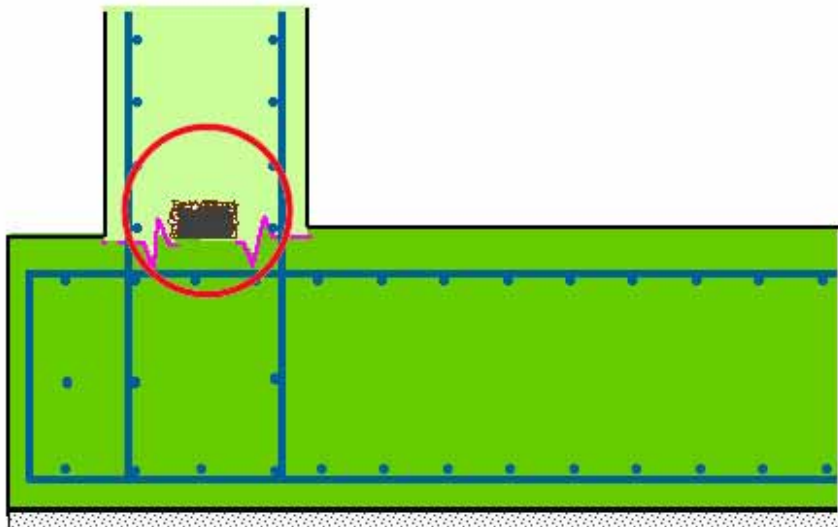
Work joint between foundation raft and wall



-  lean concrete
-  raft concrete (hard)
-  wall concrete

Choice of a BFL-Mastix band

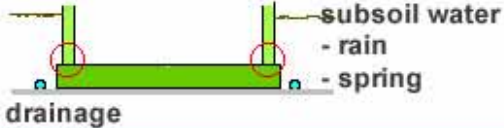
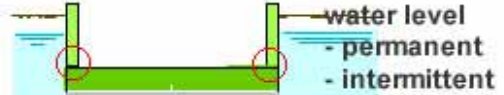
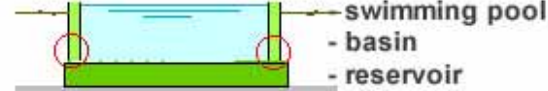
risk of water infiltration	bands
 <p>subsoil water - rain - spring drainage</p>	<p>1 30/40 R</p>
 <p>water level - permanent - intermittent</p>	<p>2 20/70 R 30/40 R</p>
 <p>swimming pool - basin - reservoir</p>	

Way of application

- 1** The bands are hot glued
- 2** The bands are applied with a 2-components epoxy glue

[back](#)

B8

Work joint between foundation raft and wall

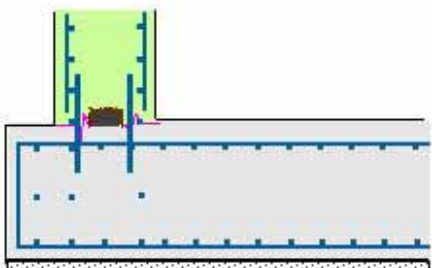
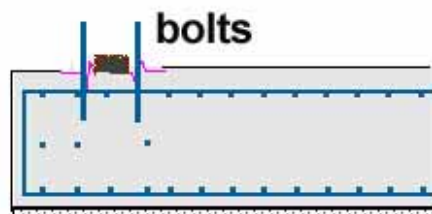
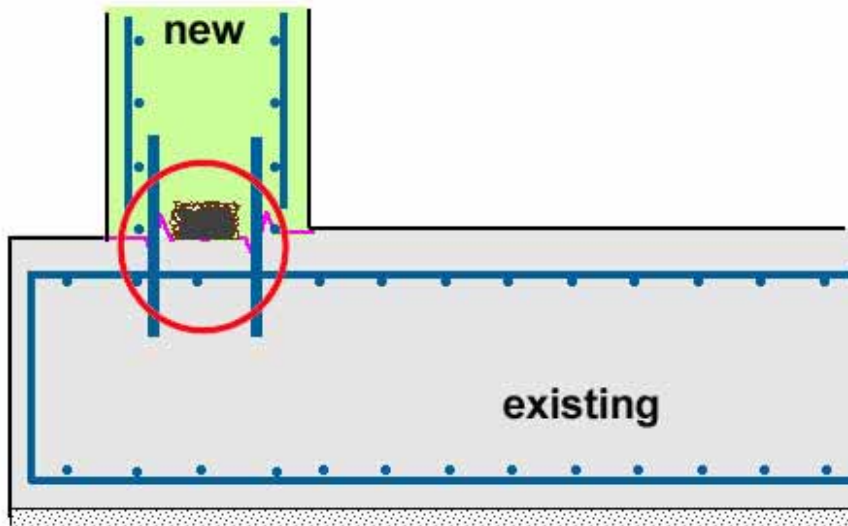

-  lean concrete
-  existing
-  new wall concrete

Choice of a BFL-Mastix band

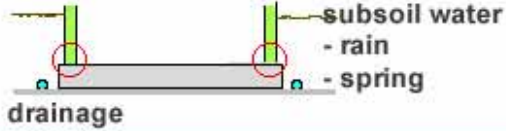
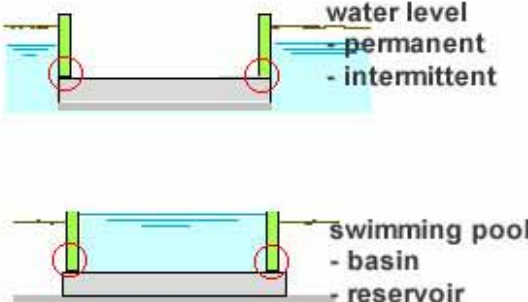
risk of water infiltration	bands
	1 30/40 R
	2 20/70 R 30/40 R

Way of application

- 1** The bands are hot glued
- 2** The bands are applied with a 2-components epoxy glue

[back](#)

B9