

mastix sa

Route Aloys-Fauquez 28
CH 1018 Lausanne

Phone +41 21 648 2949
Fax +41 21 648 3172
Email mastix@mastix.ch
Internet www.mastix.ch

BFL-Mastix bands

Joints in concrete structures

Work joint
Strinkage joint
Setting joint
Programmed shrinkage joint

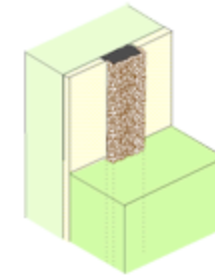
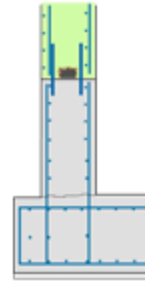
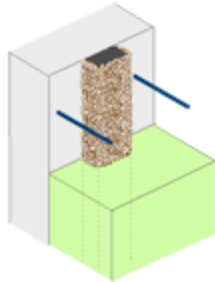
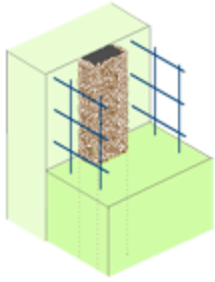

Applications

Wall - wall

work joints

shrinkage/settling joints

wall/wall

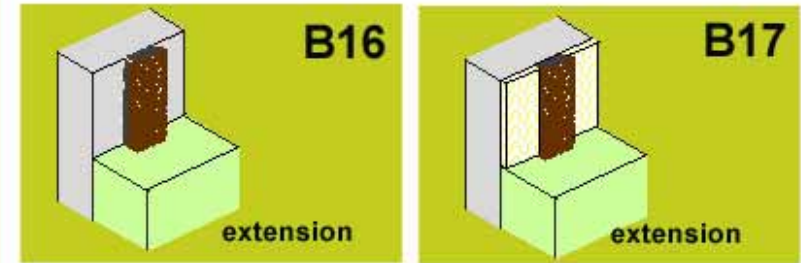
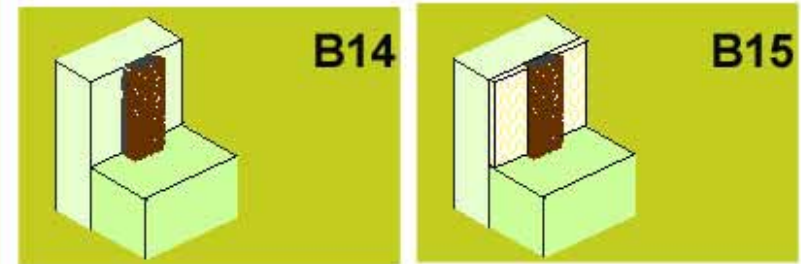
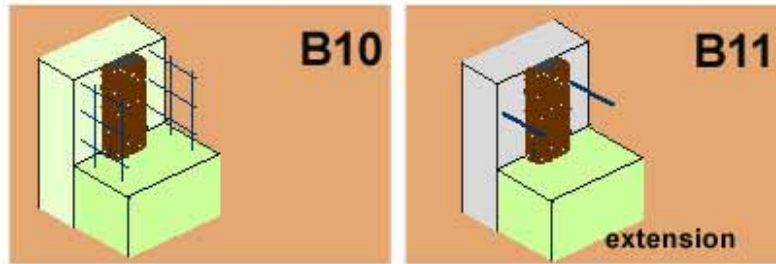

Work joint between walls

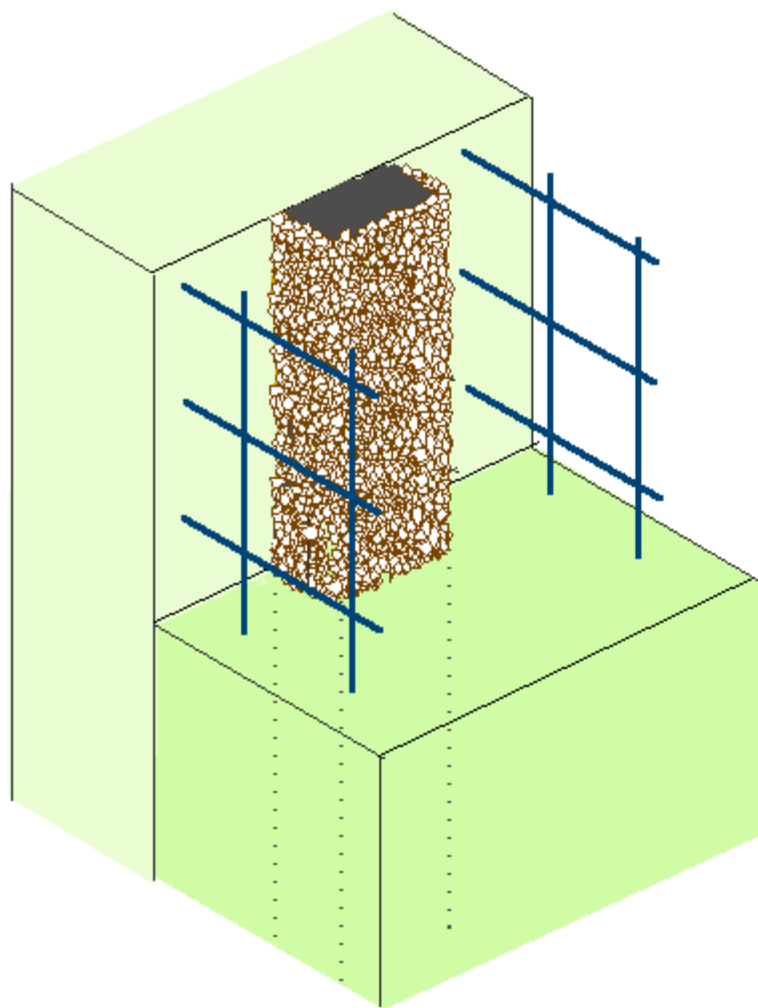

 1st concreting stage

 2nd concreting stage

Choice of a BFL-Mastix band

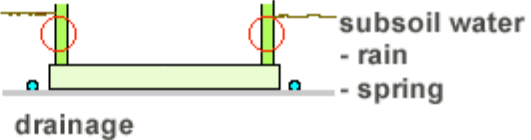
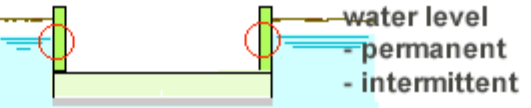
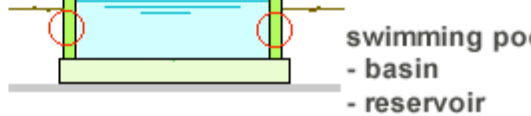
risk of water infiltration	bands
 <p>1</p>	30/40 R
 <p>2</p>	20/70 R 30/40 R
	

Way of application

- 1 The bands are hot glued
- 2 The bands are applied with a 2-components epoxy glue

[Back](#)

B10

Work joint between walls

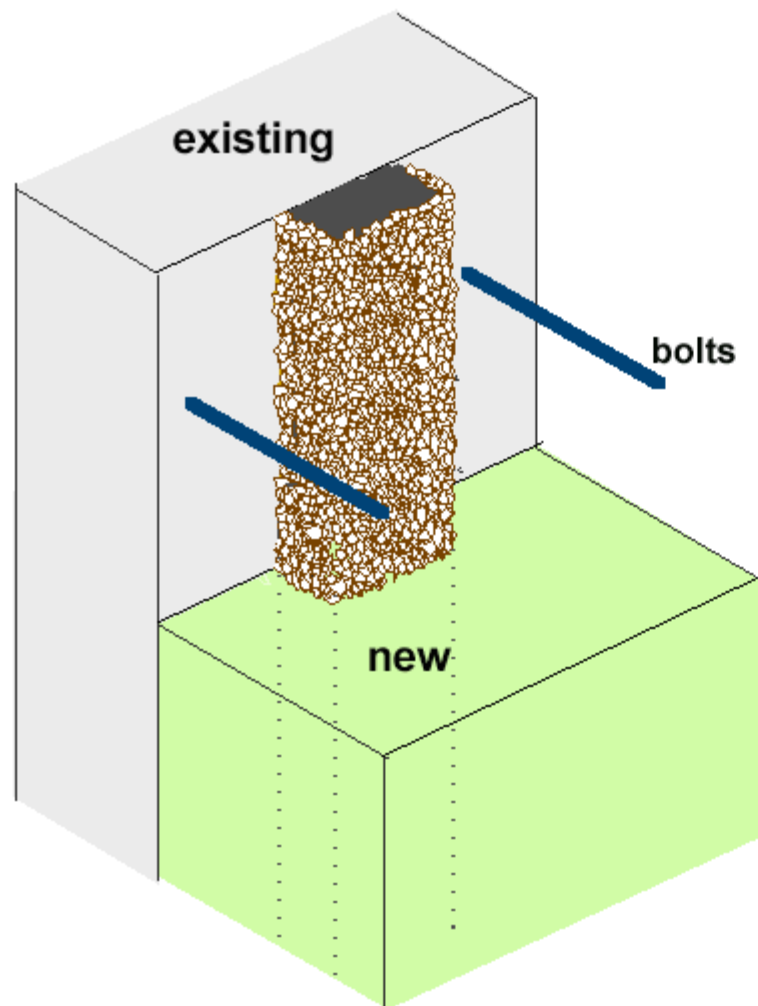

 existing

 new

Choice of a BFL-Mastix band

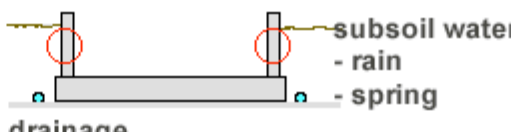
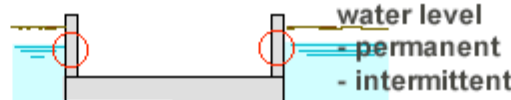
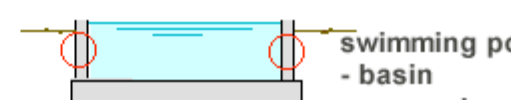
risk of water infiltration	bands
 <p>subsoil water - rain - spring drainage</p>	1 30/40 R
 <p>water level - permanent - intermittent</p>	2 20/70 R 30/40 R
 <p>swimming pool - basin - reservoir</p>	

Way of application



- 1** The bands are hot glued
- 2** The bands are applied with a 2-components epoxy glue.

[Back](#)

B11

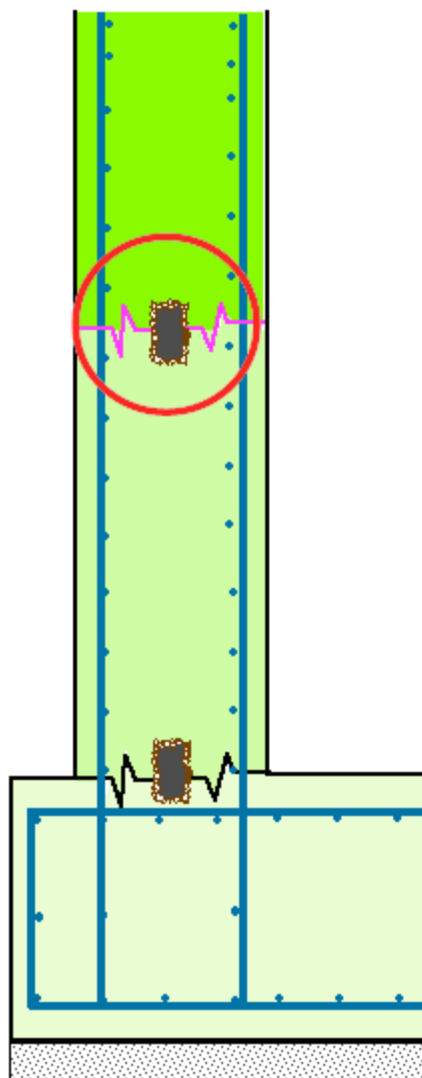
Work joint between wall concreting stages

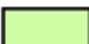

-  lean concrete
-  1st wall concreting stage
-  2nd wall concreting stage

Choice of a BFL-Mastix band

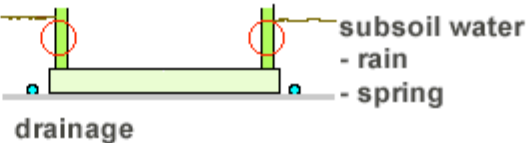
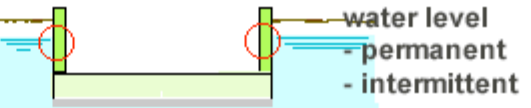
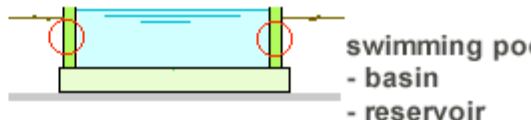
risk of water infiltration	bands
 <p>subsoil water - rain - spring drainage</p>	20/70 R4
 <p>water level - permanent - intermittent</p>	20/70 R4 40/70 R4
 <p>swimming pool - basin - reservoir</p>	

Way of application

The bands are incorporated in the fresh wall concrete.



They can remain there for several weeks, regardless the weather conditions.

[Back](#)

B12

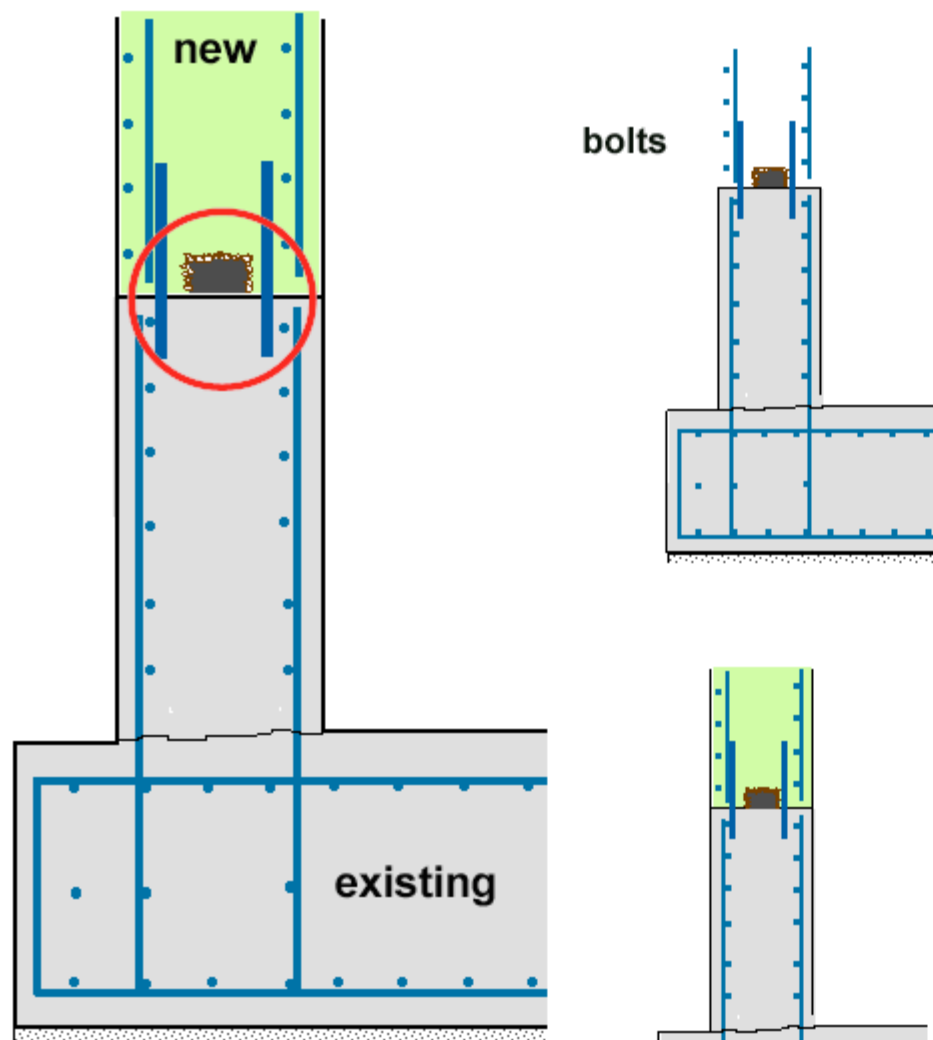
Work joint between an old wall and a new one

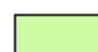

-  lean concrete
-  existing
-  new wall concrete

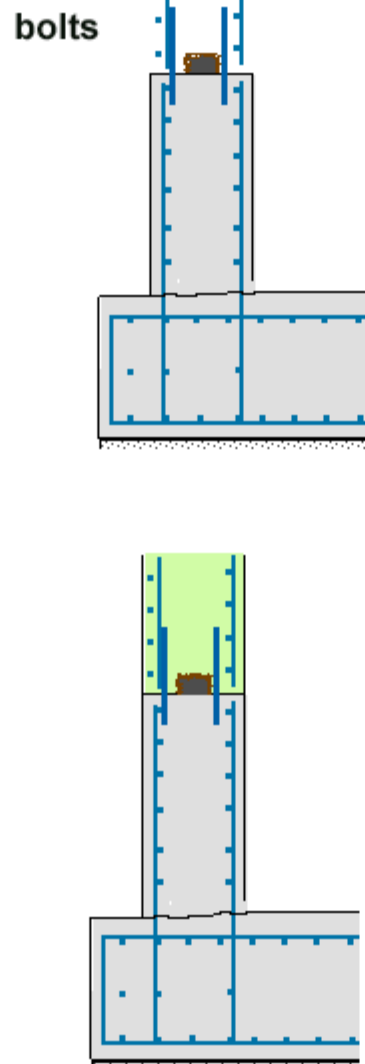

Choice of a BFL-Mastix band

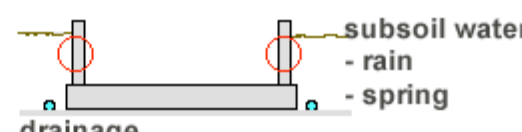
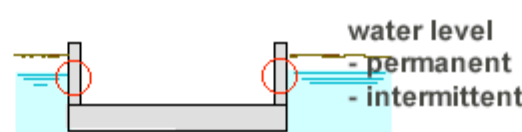
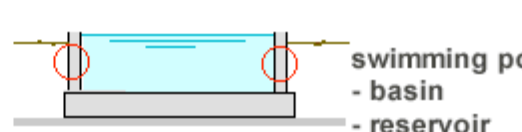
risk of water infiltration	bands
 <p>subsoil water - rain - spring drainage</p>	<p>1 30/40 R</p>
 <p>water level - permanent - intermittent</p>	<p>2 20/70 R 30/40 R</p>
 <p>swimming pool - basin - reservoir</p>	

Way of application

- 1** The bands are hot glued
- 2** The bands are applied with a 2-components epoxy glue

[Back](#)

B13

Shrinkage and settling joint between walls

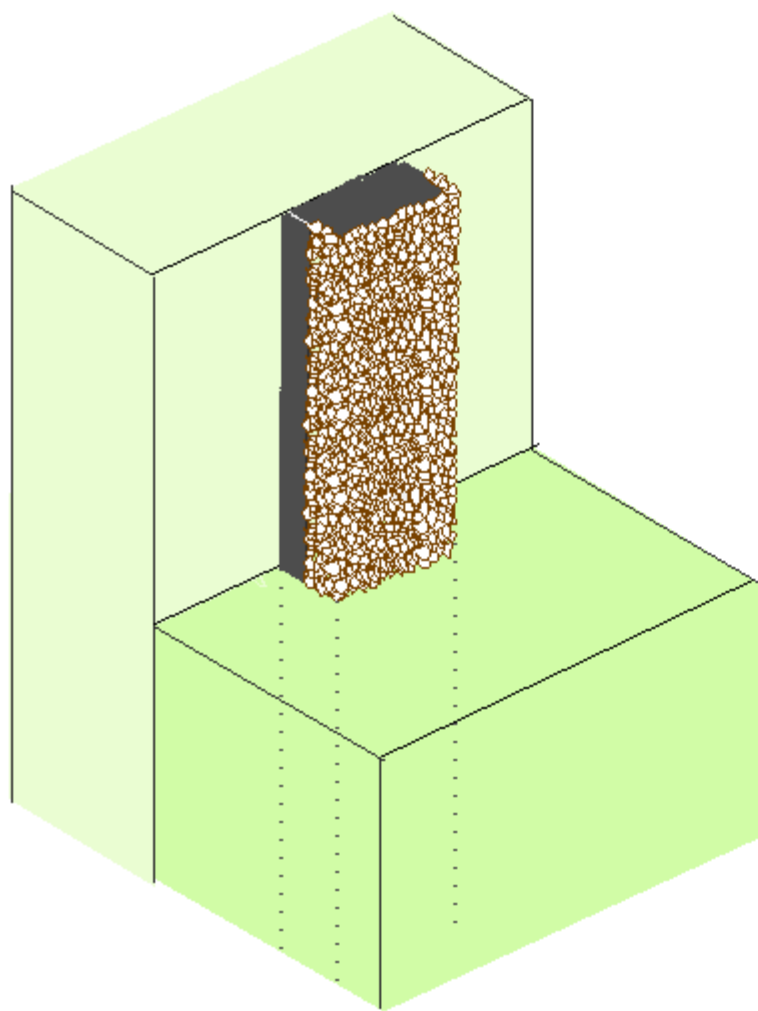

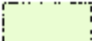
 1st concreting stage

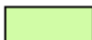
 2nd concreting stage

Choice of a BFL-Mastix band

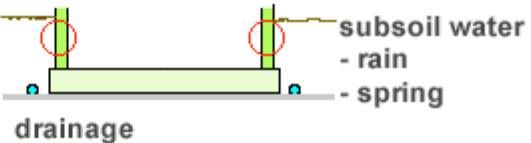
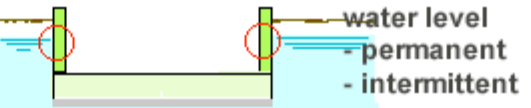
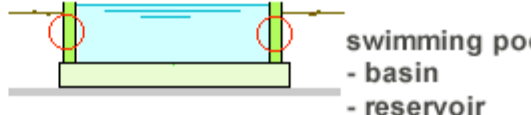
risk of water infiltration	bands
 drainage	1 40/50 R4 1/2D
 water level - permanent - intermittent	2 40/50 R4 1/2D 40/70 R4 1/2D
 swimming pool - basin - reservoir	

Way of application

- 1** The bands are hot glued
- 2** The bands are applied with a 2-components epoxy glue and a confinement string.

[Back](#)

B14

Shrinkage and settling joint between walls

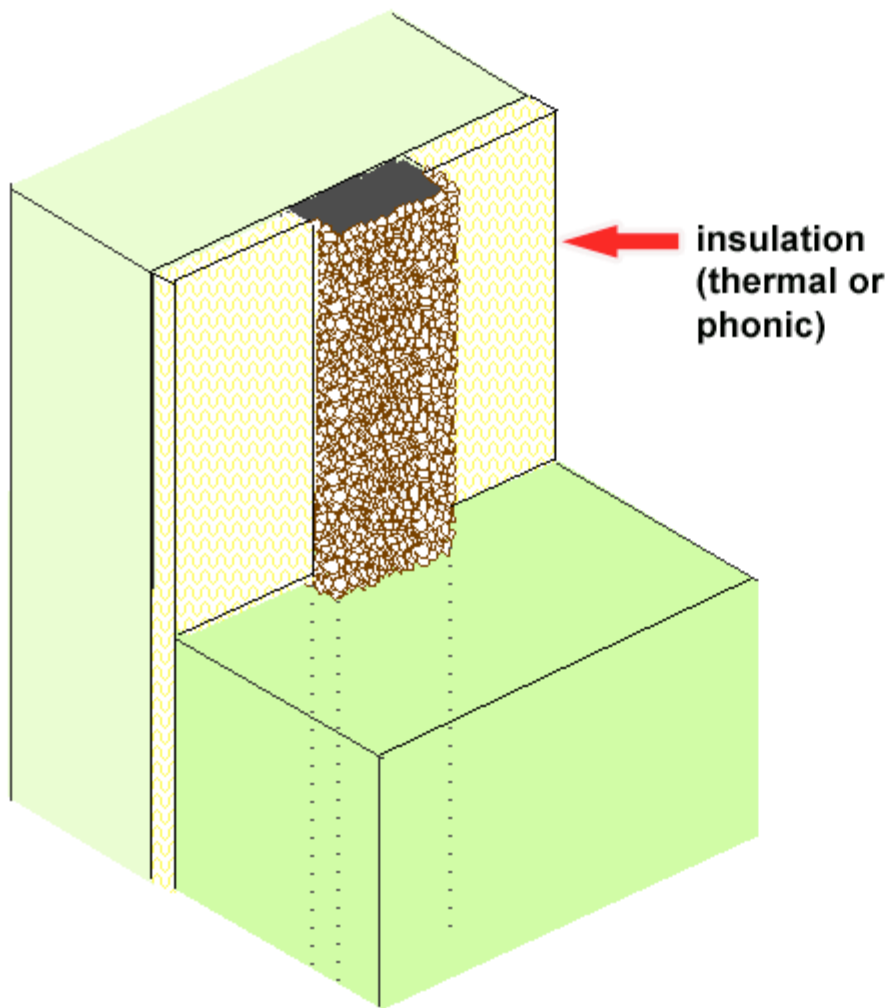

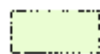
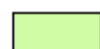
-  1st concreting stage
-  2nd concreting stage

Choice of a BFL-Mastix band

risk of water infiltration

bands

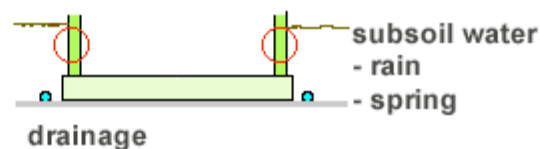

1 40/50 R4 1/2D

Way of application



- 1** The bands are hot glued with a 2-components epoxy glue.

[Back](#)

B15

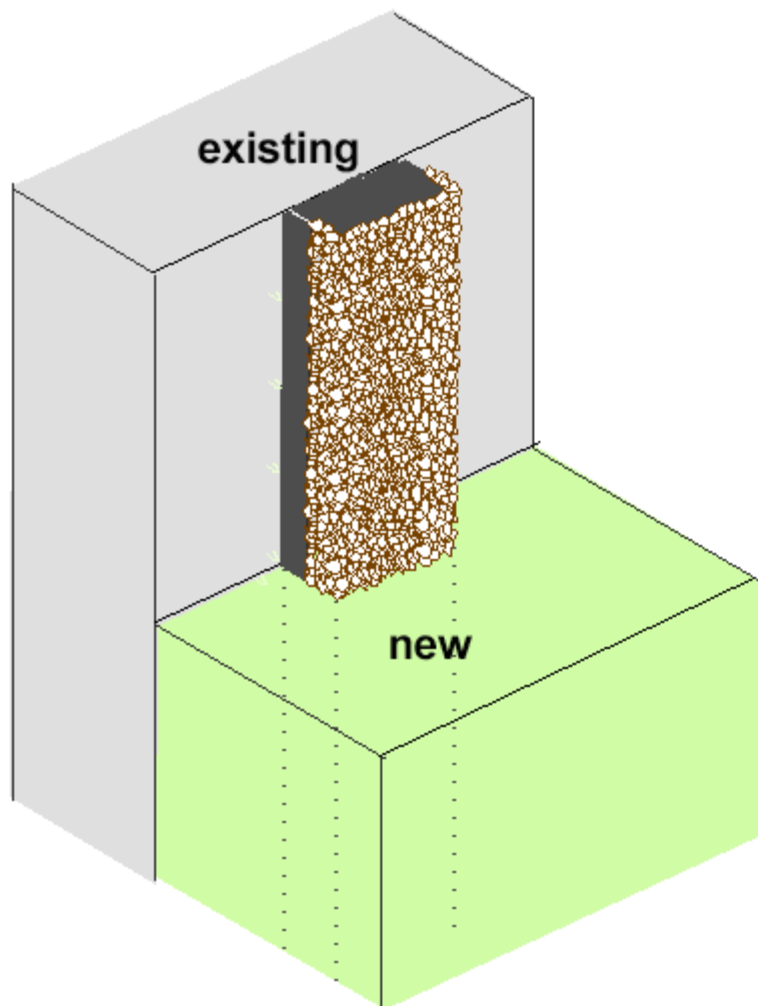
Shrinkage and settling joint between an old wall and a new one



 existing
 new wall concrete

Choice of a BFL-Mastix band

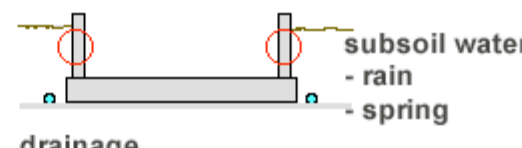
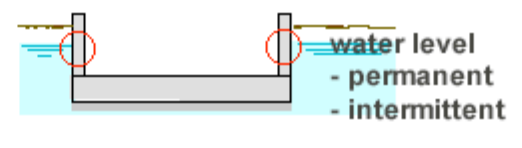
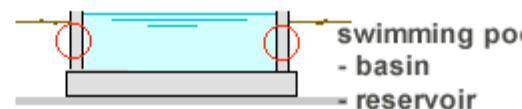
risk of water infiltration	bands
 <p>subsoil water - rain - spring</p> <p>drainage</p>	<p>1 40/50 R4 1/2D</p>
 <p>water level - permanent - intermittent</p>	<p>2 40/50 R4 1/2D 40/70 R4 1/2D</p>
 <p>swimming pool - basin - reservoir</p>	

Way of application

- 1** The bands are hot glued
- 2** The bands are applied with a 2-components epoxy glue and a confinement string.

[Back](#)

B16

Shrinkage and settling joint between an old wall and a new one

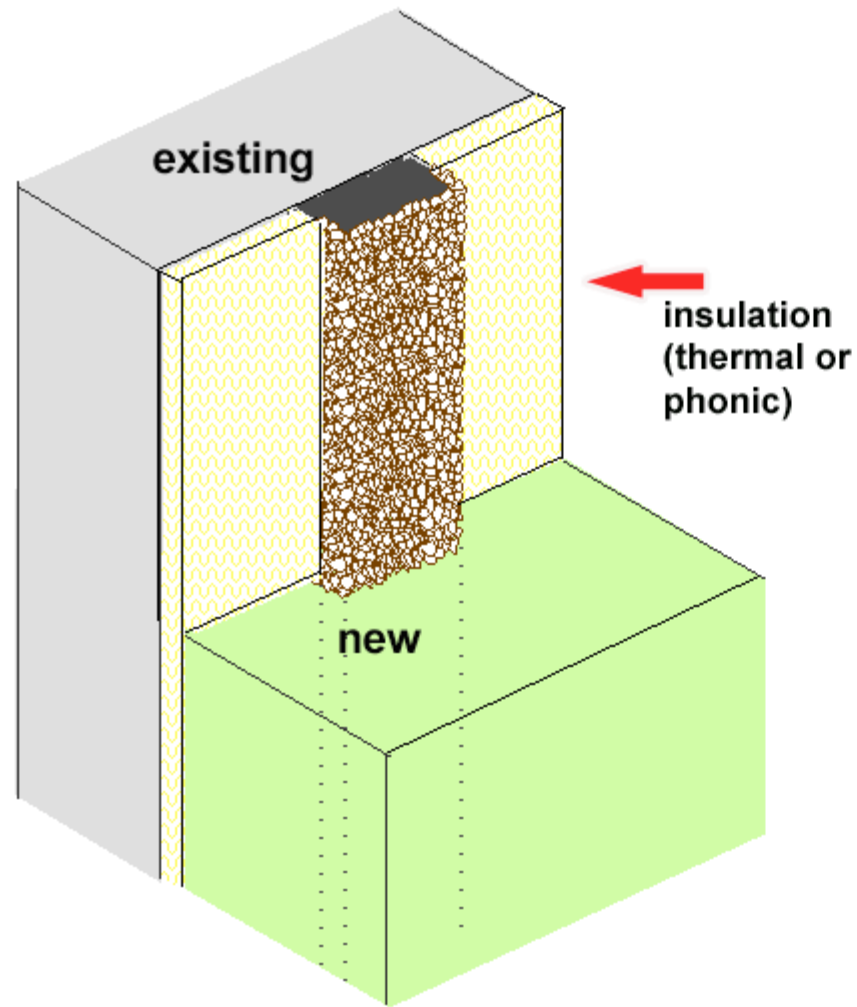

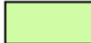
 existing
 new wall concrete

Choice of a BFL-Mastix band

risk of water infiltration

bands

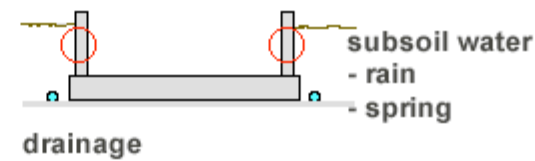

1 40/50 R4 1/2D

Way of application

- 1** The bands are hot glued with or with a 2-components epoxy glue.

[Back](#)

B17