

BFL-Mastix bands

type R4 1/2 D

are used for waterproofing construction joints in the presence of foundation ground settlement and of long term concrete shrinkage.

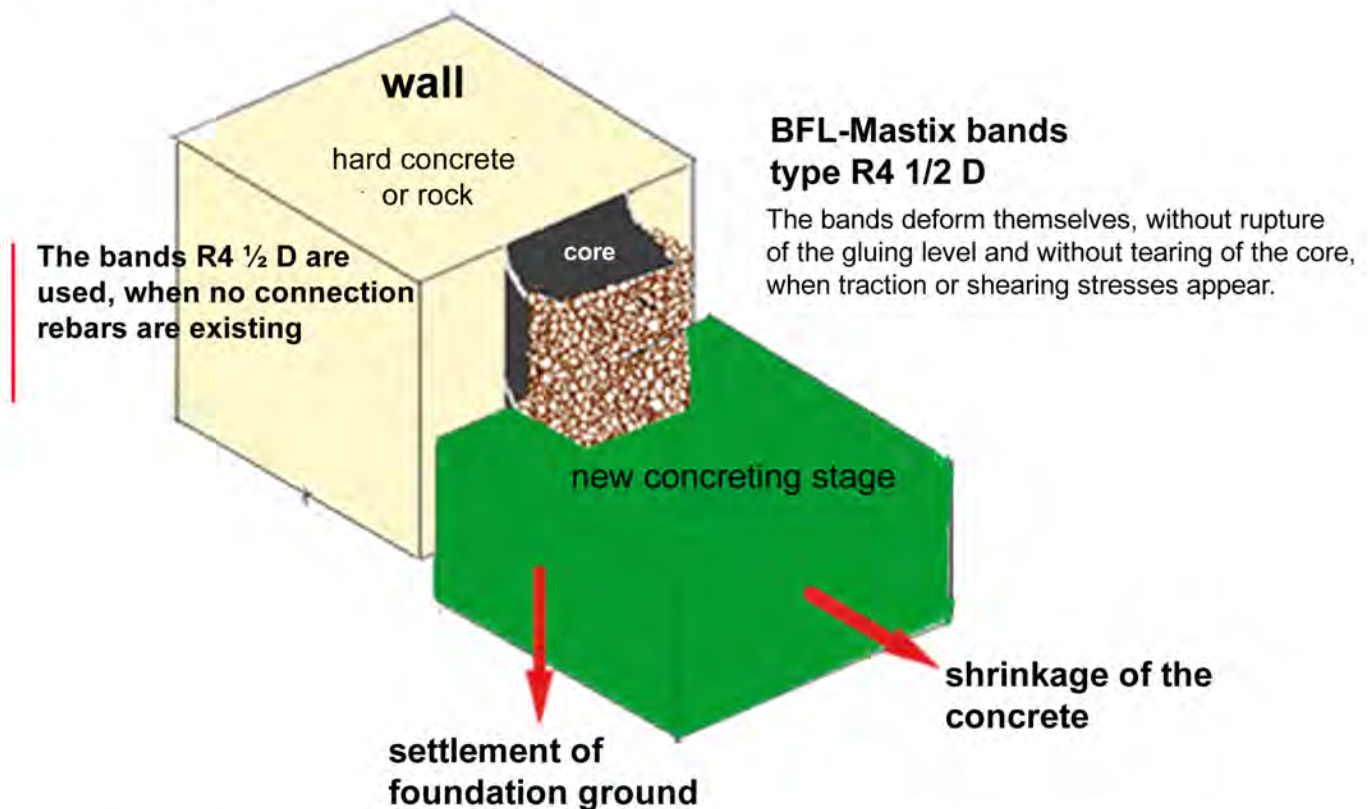

The bands type R4 1/2 D consist of a core that is covered on half its perimeter with a special fine crushed gravel.

The core of the BFL-Mastix bands type R4 1/2D consists of a bitumen/rubber mixture, comparable with a liquid of high viscosity.

The half, non-gravel coated perimeter is used as elastic reserve to absorb shrinkage and settlement movements in the structure.

The special non-alkali reactive gravel covering the core, assures an intimate and watertight connection with the fresh concrete.

For gluing the bands type R4 1/2 D with a 2-components epoxy glue, the bonding « SIKA Anchor Fix 3+ » or equivalent can be used.

Please consult our pdf-file 9 F for the gluing procedure of bands R4 1/2 D

BFL-Mastix bands type R4 1/2 D

The **BFL-Mastix bands type R4 1/2 D** consist of a core, which is covered on half the perimeter with a special fine crushed gravel. The gravel-free perimeter is the elastic reserve to absorb movements

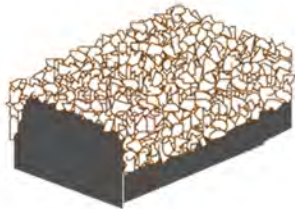

elastic reserve

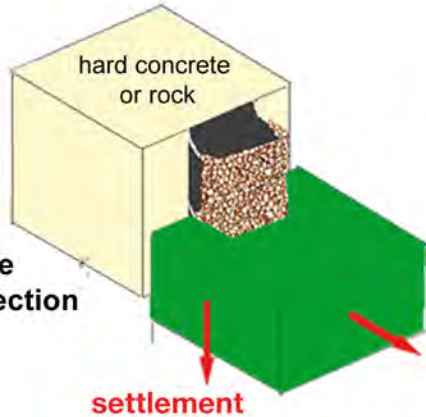

The bands R4 1/2 D are used, when no connection rebars are existing

Profile	retreat	settlement
30/40 R4 1/2 D	2 mm	4 mm
40/50 R4 1/2 D	2 mm	6 mm
40/70 R4 1/2 D	4 mm	8 mm

settlement

retreat

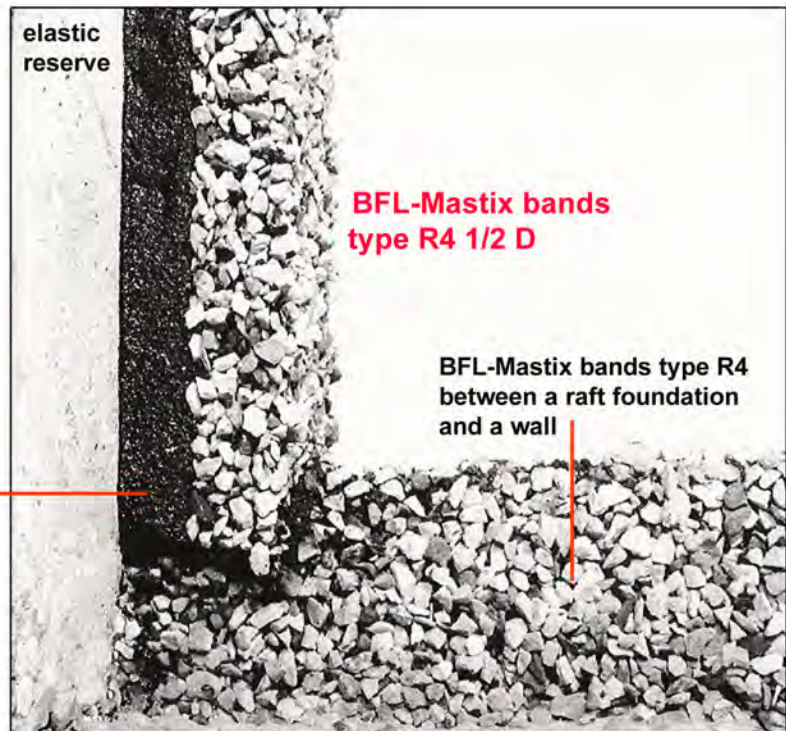

For gluing the bands type R4 1/2 D with a 2-components epoxy glue, the bonding « SIKA Anchor Fix 3+ » or equivalent can be used.

1 Retreat joint around piles in groundwater

BFL-Mastix bands type R4 1/2 D are chemically glued around the piles. They are kept in position by a spanner until the glue has completely hardened

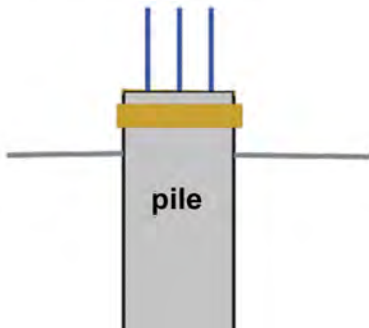

A strap around the band on the pile during the hardening period of the glue, is to maintain the band in its correct position.



The BFL-Mastix bands assure the watertightness of the structure, acting like a barrier against water, passing between pile and raft.

2 Retreat and settlement joint between two concreting stages of a raft.

BFL-Mastix bands type R4 1/2 D are thermally or chemically glued on the hard concrete of the first stage.

Both concreting stages are not connected by rebars.



3 Retreat and settlement joint between an existing and a new raft foundation.

The BFL-Mastix bands type R4 1/2 D are chemically glued on the existing raft concrete.

Both concreting stages are not connected by rebars.

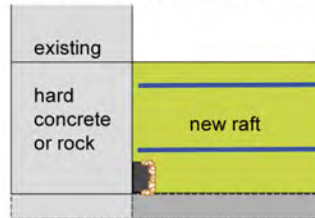

lateral glue cord

elastic reserve

special fine crushed gravel incrustated on the band core

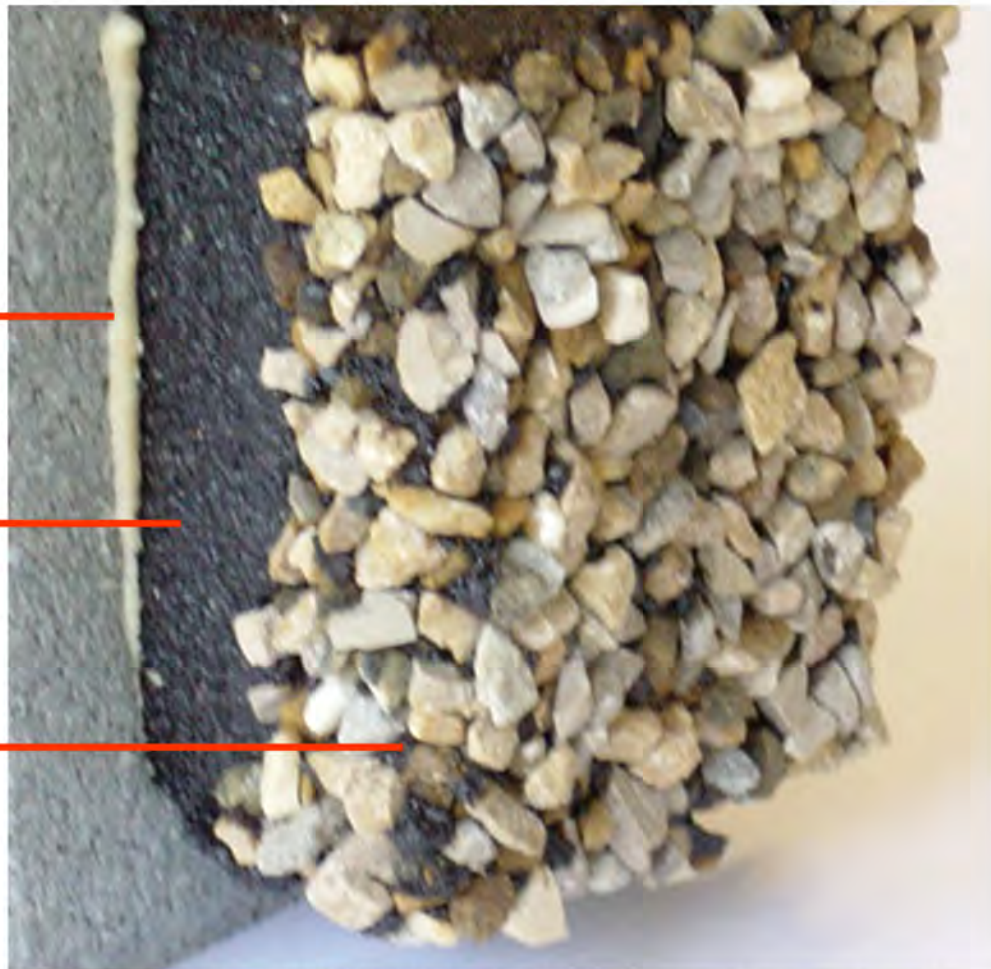

BFL-Mastix band type 40/70 R4 1/2 D glued with a 2-components epoxy glue with lateral cord, assuring a long term security.

4 Retreat and settlement joint between an existing and a new raft foundation with insulation.

The BFL-Mastix bands type R4 1/2 D are chemically glued on the concrete of the existing raft.

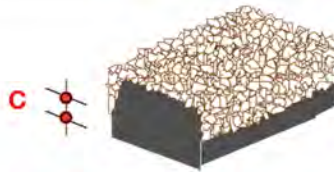
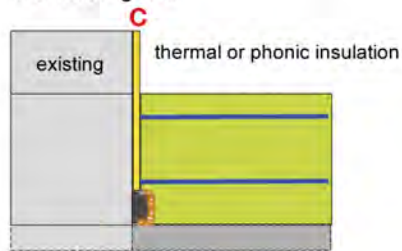

Profile	R4 1/2 D	C
30/40	R4 1/2 D	1
40/50	R4 1/2 D	2
40/70	R4 1/2 D	2

5. Retreat and settlement joint between two concreting stage of a wall.

The BFL-Mastix bands type R4 1/2 D are chemically glued on the wall concrete of the first stage.

Hydro-electric dams

This solution is also valid for waterproofing joints between the concrete blocks.

This solution is also valid for joints between rock and a new concrete structure.



Profile	retreat	settlement
30/40 R4 1/2 D	2 mm	4 mm
40/50 R4 1/2 D	2 mm	6 mm
40/70 R4 1/2 D	4 mm	8 mm

6. Retreat and settlement joint between two concreting stages of a wall with insulation

The BFL-Mastix bands type R4 1/2 D are chemically glued on the wall concrete of the first stage.

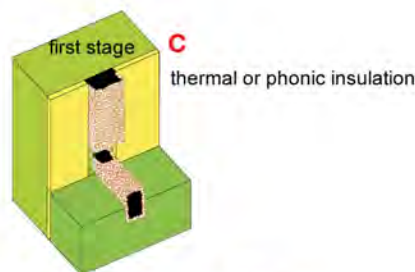

Profile	R4 1/2 D	C
30/40	R4 1/2 D	1
40/50	R4 1/2 D	2
40/70	R4 1/2 D	2